

MovinCool® Climate Pro® K Series

MovinCool Climate Pro K12



FAMILY FEATURES

- Sleek, modern design
- Wrap around bumper system protects against scratches & dents
- Built-in exhaust flanges with protective grille
- Condensate tank hidden behind easy-open access door
- Convenient cord storage cubby on rear of unit
- Connectivity enabled

PERFORMANCE

| | |
|-------------------------------|---------------------|
| Ambient Operating Range | 65-95°F |
| Cooling Capacity | 12,000 Btu/h |
| Supply Airflow h/m/l cfm | 410/380/330 |
| Max Supply/Cold Duct Length | 30 feet |
| Exhaust Airflow h/m/l cfm | 760/700/640 |
| Max Hot/Exhaust Duct Length | 60 feet |
| Sound Level High (w/out duct) | 61 dB |

APPLICATION

| | |
|------------------------------|---|
| Voltage @ 60Hz | 115 |
| Recommended Breaker Size (A) | 15 |
| Amps (A) | 10.3 |
| Min/Max Voltage | 104-127 |
| Power Cord Gauge | 14AWG-3 Core |
| Power Cord Length | 10 feet |
| Plug Receptacle Requirement |  NEMA 5-15P |

SHIPPING/LOGISTICS/ HANDLING/QUALITY

| | Shipping | Out of Carton |
|---------------|----------|---------------|
| Weight (lbs.) | 208 | 166 |
| Height (in.) | 54 | 47 |
| Width (in.) | 26 | 22 |
| Depth (in.) | 31 | 27 |

RoHS Restriction of Hazardous Substances Standard compliant
UL 60335 and UL 60335-2-40 compliant

MovinCool Climate Pro K12

ACCESSORIES

NOZZLE APPLICATION

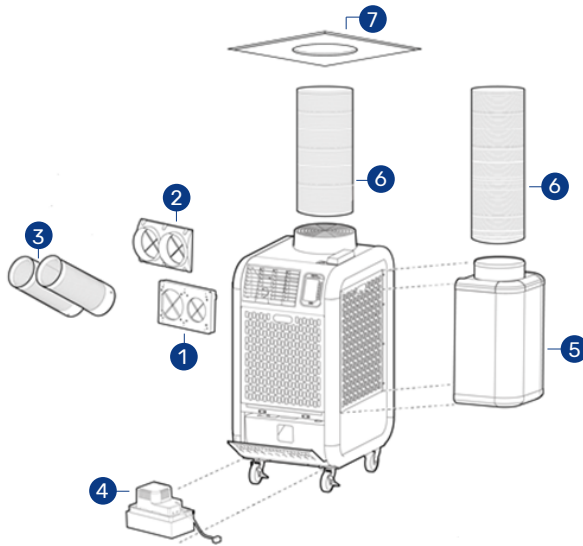

| # | Part No. | Description |
|---|---------------|---|
| 1 | 481769-0280 | 5" Two Hole Base Plate |
| 2 | 481170-0480 | 5" Two Hole Quick Connect Flange |
| 3 | 484209-0480 | 5" Quick Connect Nozzle** |
| 4 | 484789-0210 | Condensate Pump, 115v |
| 5 | 484350-1160 | Plenum Condenser Air |
| 6 | LA481744-0410 | 12" Self-Supported Duct |
| 7 | 484490-1030 | Ceiling Tile Kit, 12-in hole, metal |
| * | LA146373-8280 | Ceiling Tile Kit, 12-in hole, plastic |
| * | LAY45771-0060 | Flexible Air Duct, 8' by 12" |
| * | HDK-12 | 2' x 2' Ceiling Tile with 8' of 12" Flex Duct |

* Not Pictured

** Sold Individually

DUCT HOSE APPLICATION

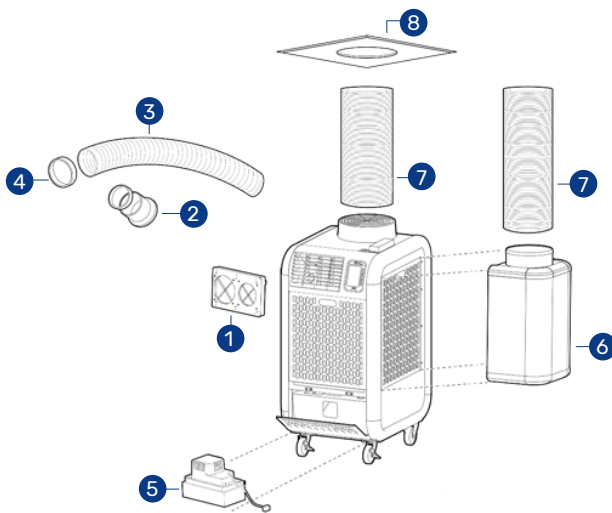

| # | Part No. | Description |
|---|---------------|---|
| 1 | 481769-0280 | 5" Two Hole Base Plate |
| 2 | 481170-0450 | 5" Flange Ext. Duct** |
| 3 | LA481744-0420 | 5" Self-Supported Duct** |
| 4 | 481851-0200 | 5" Trim Ring** |
| 5 | 484789-0210 | Condensate Pump, 115v |
| 6 | 484350-1160 | Plenum Condenser Air |
| 7 | 481744-0062 | 12" Self-Supported Duct |
| 8 | 484490-1030 | Ceiling Tile Kit, 12-in hole, metal |
| * | LA146373-8280 | Ceiling Tile Kit, 12-in hole, plastic |
| * | LAY45771-0060 | Flexible Air Duct, 8' by 12" |
| * | HDK-12 | 2' x 2' Ceiling Tile with 8' of 12" Flex Duct |

* Not Pictured

** Sold Individually